

CHRISTIANSBURG COLORED SCHOOL

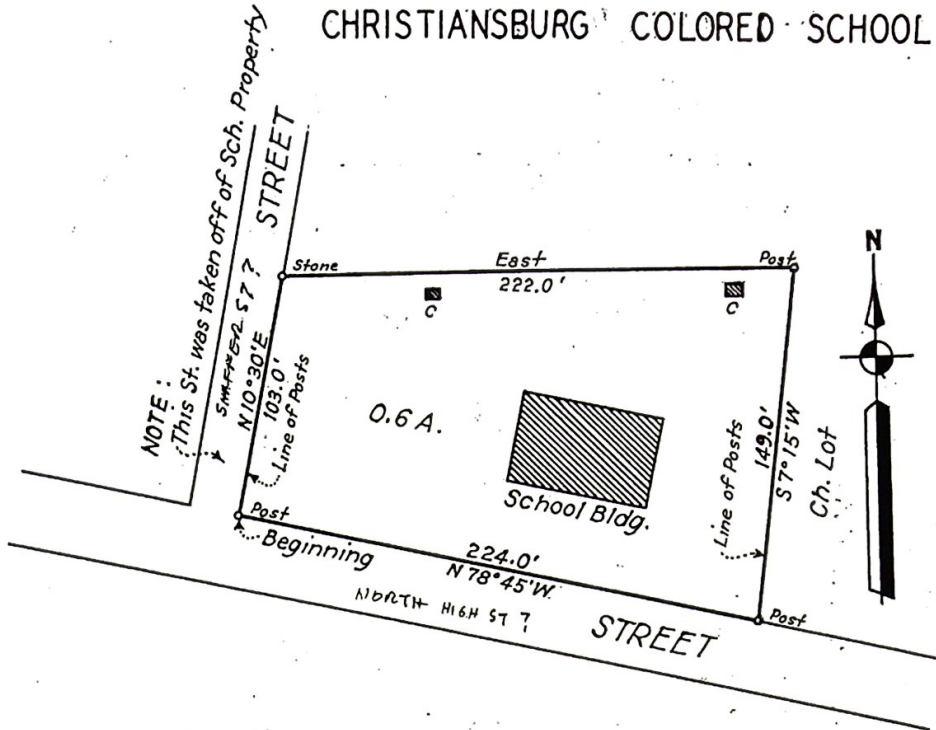

*Eto
4-22-38
Presented to
D.C. Hall*

Scale 1" = 50'
Childress Hall
1-31-38

This parcel conveyed by
Sch Bd 10 May 1938
S.B. Morgan et al's DB 193-410

PROPERTY ACQUIRED FROM FRIENDS' FREEDMAN'S ASS'N.

Recorded in the Clerk's Office of Montgomery County, Virginia.
Deed Book 99, Page 212.

Lying between the town of Christiansburg and Cambria and Cambria and adjoining the colored church property and is more particularly described as follows:

Beginning at a post on the north side of a street; thence N 10° 30' E 103.0 feet to a stone; thence East 222.0 feet to a post, a corner of church lot; thence with the church lot S 7° 15' W 149.0 feet to a post on the north side of a street; thence along the north side of said street N 78° 45' W 224.0 feet to the beginning and containing 0.6 of an acre of land.

VIRGINIA: In the Clerk's Office of the Circuit Court of Montgomery County 8th day of April, 1938.

The foregoing map was this day presented in said Office and with certificate annexed admitted to record at 3:50 o'clock P. M.

Teste:

A. B. CORRELL, Clerk.

By *W.H. Willard*, D. C.